

## B3: Bunker feeder module

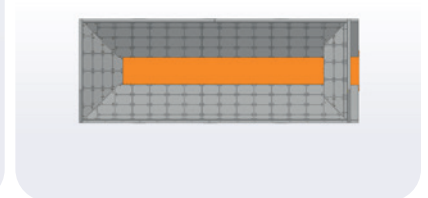
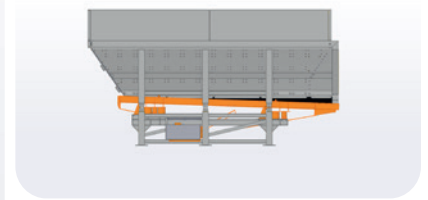
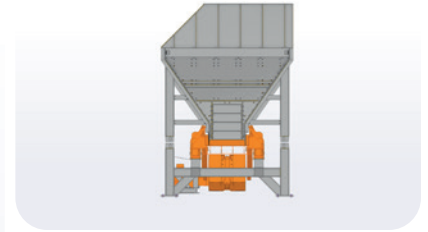
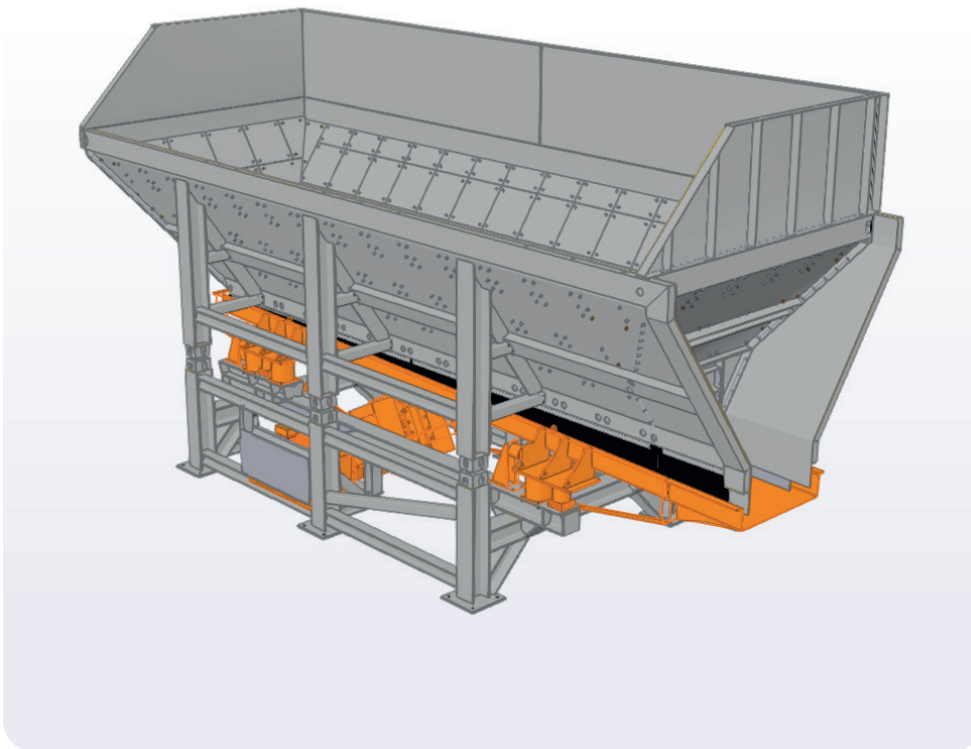

### Description

- 25 m<sup>3</sup> bunker feeder module
- SPALECK vibration feeder
- Container-frame based construction for easy set-up, breakdown and transportation
- Totally galvanized construction (IBA-proof!)
- Fully equipped HARDOX® lining in trough and vibration feeder
- Control cabinet IP65 'outside' version provided with TRS Modular Plant Control System (MPCS), for stand-alone control or in combination with other modules.

### Dimensions

#### Transport:

2 truck loads

#### Operational:

8,0 x 3,0 x 3,5m (l x w x h)

#### Weight

Ca. 15t

#### Installed power

15kW

### Applications

- IBA (bottom ash) – waste – metals - shredder residues

